

Intelligent Sensor Soap Dispenser

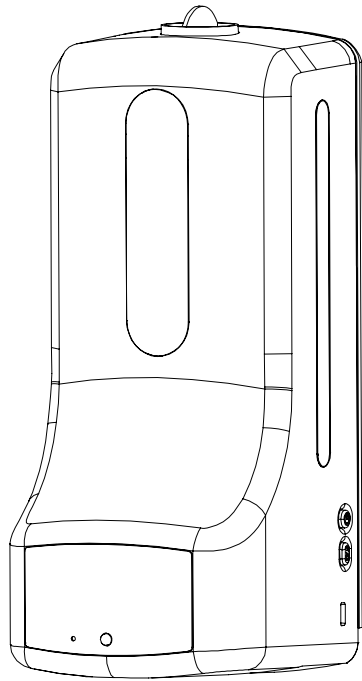

Appearance

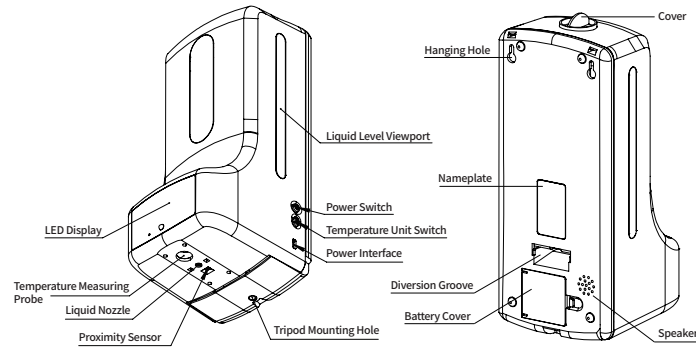

Specification

1. Accuracy: $\pm 0.2^{\circ}\text{C}$ (34~45 $^{\circ}\text{C}$, put it in the operating environment for 30 minutes before use)
2. Alarm type: flashing + bleeping "DIDIDI"
3. Measuring distance: 5cm~10cm
4. LED display: Number
5. Interface: Type-C
6. Bottle Capacity: 1000mL
7. Mounting Type: Wall-hanging, Tripod-fixed
8. Working Temperature: 10 $^{\circ}\text{C}$ ~40 $^{\circ}\text{C}$ (15 $^{\circ}\text{C}$ ~35 $^{\circ}\text{C}$ Recommended)
9. Measuring range: 0~50 $^{\circ}\text{C}$
10. Response time: 500ms
11. Standby time: 5s for non-working, dynamic loop with white light
12. Power Supply: DC 5V 1500MA (or 4 AA batteries)
13. Dimension: 119*133*280mm
14. Liquid type: hand sanitizer or liquid disinfectant

Conditions

1. Standby: the white dot on the bottom of right corner flashing by turns. (Fig. 1)



(Fig.1)

2. Normal temperature: displays current temperature and green light flashes once on the display. (Fig. 2)

36.2 (Fig. 2)

3. Abnormal temperature: displays current temperature and red light flashes on the display. (Fig. 3)

38.0 (Fig. 3)

4. Out of measuring range (Note: do not spray hand sanitizer): "Lo": Ultra-low temperature alarm. (Fig. 4); "Hi": Ultra-high temperature alarm. (Fig. 5)

Lo (Fig. 4)

Hi (Fig. 5)

Instructions

1. Temperature measuring and hand washing: Put your hand on the bottom until you hear a "DI" sound, then the LED screen will display the temperature and hand sanitizer squeezed out. (Fig. 6)

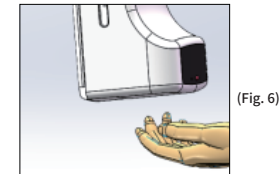

(Fig. 6)

2. Function of button:

(1) Button ①: Function setting (Fig. 7)

(2) Button ②: Specific function settings (Fig. 8)



(Fig. 7)

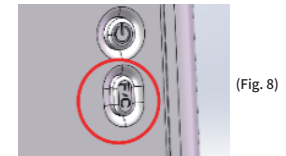

(Fig. 8)

3. Function setting

Press the button ① once to set the temperature unit

Press the button ② to switch between Celsius and Fahrenheit

C: Celsius F: Fahrenheit (Fig. 9, Fig. 10)

C (Fig. 9)

F (Fig. 10)

Press the button ① twice to set the working mode

Press the button ② to switch the working mode. Bo: body mode co: counting mode sur: surface mode

BOD COU SUR

Press the button ① 3 times to set the alarm temperature

Press the button ② to switch the alarm temperature between 36 $^{\circ}\text{C}$ to 39 $^{\circ}\text{C}$

36.0 — 39.0

Press the button ① 4 times to set the volume

Press the button ② to switch the volume from U0 to U4

U0 — U4

Press the button ① 5 times to set the language

Press the button ② to set the language CH/EN/KO/PT/ES

CH: Chinese EN: English KO: Korean PT: Portuguese ES: Spanish

CH EN KO PT ES OFF

Press the button ① 6 times to set the squeeze amount of hand sanitizer

Press the button ② to set the extrusion time between 0.1 and 2.0 seconds

E0.1 — E2.0

Press the Button ① for 2S or more: on/off

Mounting

(1) Tripod mounting: There is screw connection on the bottom which can be connected with tripod. (Fig. 11)

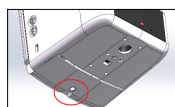

(Fig. 11)

(2) Wall-hanging: There are two hanging holes on the back side which can be fixed with nail. (Fig. 12)

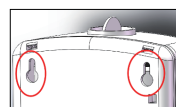

(Fig. 12)

(3) Desktop stand: Put the Intelligent Sensor Soap Dispenser in the desktop stand to use (Fig. 13)

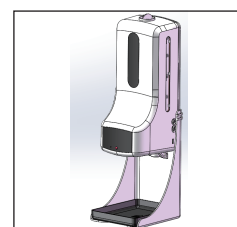

(Fig. 13)

(4) Wall-hanging Desktop stand: there are two hanging holes on the back side which can be fixed with nail. (Fig. 14)

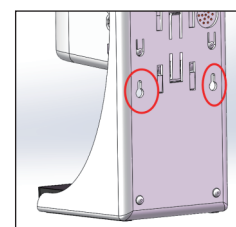

(Fig. 14)

(5) Hanging the desktop stand on the tripod (Fig. 15)

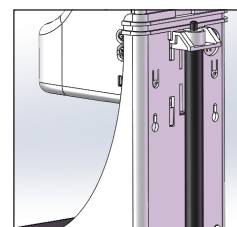

(Fig. 15)

(6) Power On/Off: Press the switch button on the right side of the device (Fig. 16)

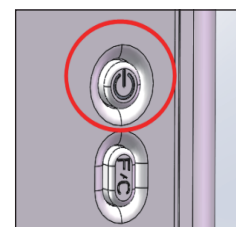

(Fig. 16)

(7) Battery installation: Open the battery cover, take out the battery box, unscrew the screws and put in 4 AA batteries (Fig. 17).



(Fig. 17)

Warnings

1. Do not pour hand sanitizer into Temperature Measuring Probe and Proximity Sensor.
2. Make sure that it is standing upright after filling in hand sanitizer.